

# TUSCANY®

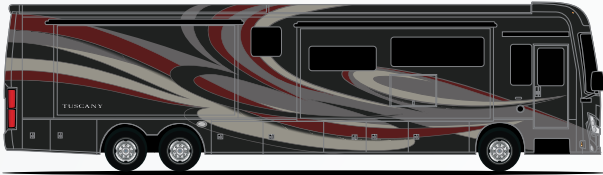

CHALET



KINGSTON

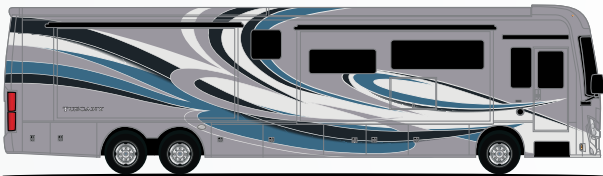

OCEAN DRIVE

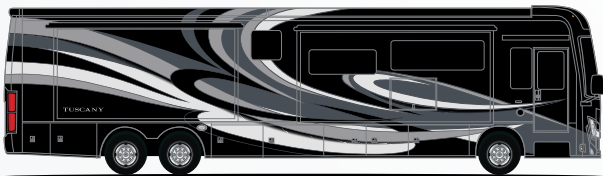

SHADOW MOUNTAIN

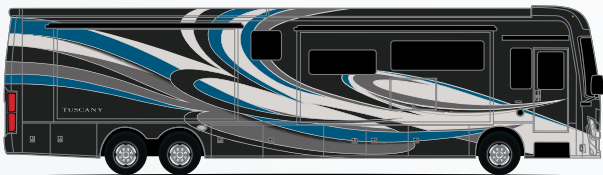

WATERFRONT

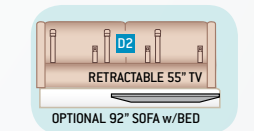
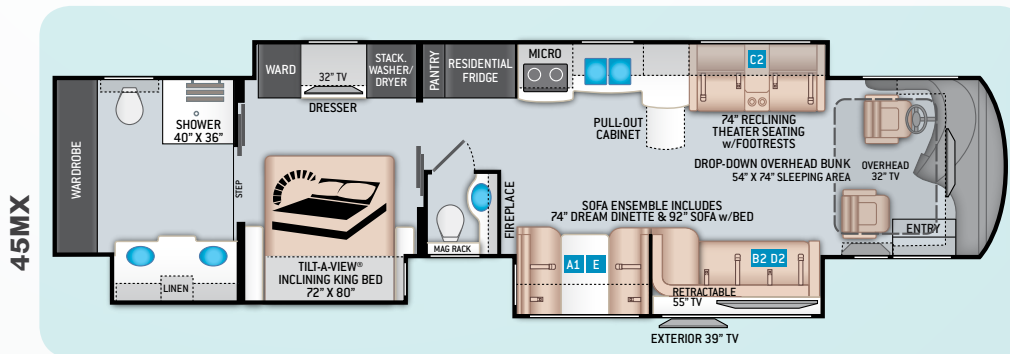
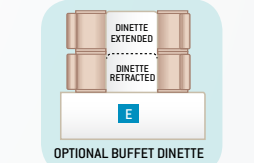
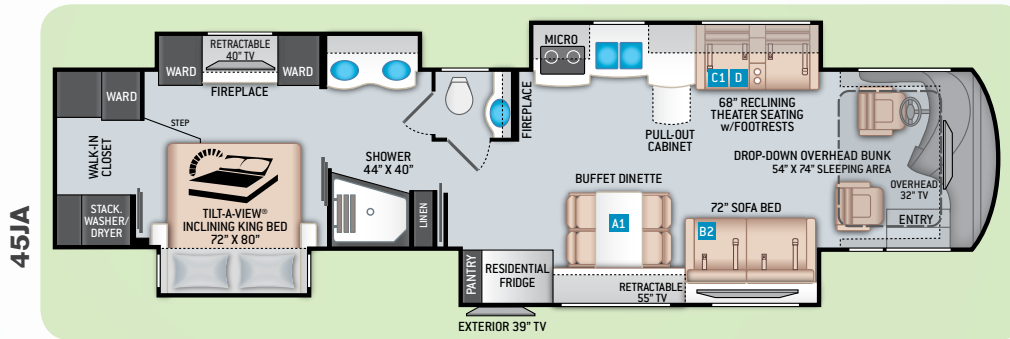
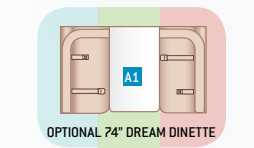
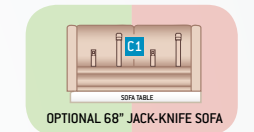
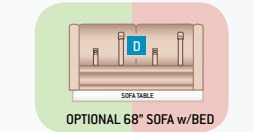
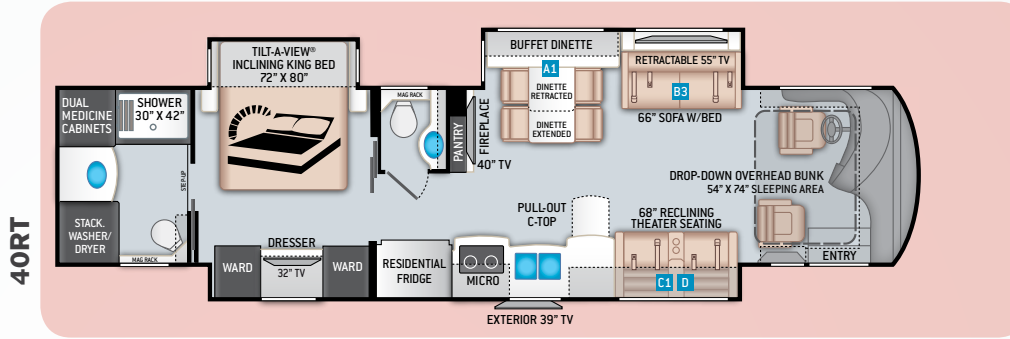

# Featured Highlights

## CONSTRUCTION & EXTERIOR

- Freightliner® XC-R Raised Rail Chassis with Atlas™ Foundation
- Side Radiator Cooling Package
- Cummins® ISL 8.9L Engine with 450HP & 1,250 lb.-ft. Torque
- In-Block 1,000-watt Engine Heater
- 6-Speed Allison MH-3000 Automatic Transmission
- ZF® Independent Front Suspension
- Full Air Front Disc & Rear Drum Anti-Lock Brakes
- Exhaust Brake (40RT)
- 2-Stage Jacobs® Brake (45JA & 45MX)
- Air-Ride™ Suspension
- Sachs® Shock Absorbers
- 150-gallon Fuel Tank with Dual Fills
- Driver Side DEF Tank Fill (40RT)
- Dual DEF Tank Fill (45JA & 45MX)
- One-Piece Fiberglass Front & Rear Caps
- One-Piece Tinted Windshield
- Molded Fiberglass Roof
- Full-Body Paint Package with Gel-Coat Sidewalls with Invisible Front Mask Paint Protection
- Full Width Stainless Steel Stone Guard with Tuscany® Emblem
- Automatic Leveling Jacks with Touchpad Controls
- Side-Hinged Locking Compartment Doors with Electronic Locks
- Lighted Storage Compartments
- Basement Pass-Through Storage
- Easy Slide Storage Tray
- Dual Roof Mounted Power Patio Awnings with Integrated LED Lighting
- Power Entry Door Awning with Integrated LED Lighting
- Slideout Room Topper Awnings with Aluminum Covers
- Frameless Dual Pane Windows
- Patio Light on Road Side & Curbside
- 10,000-lb. Trailer Hitch with 7-pin

- Round Connector (40RT)
- 15,000-lb. Trailer Hitch with 7-pin Round Connector (45JA & 45MX)

## AUTOMOTIVE & COCKPIT

- 15.7" In-Dash Touchscreen Media Center with SiriusXM® Radio, Garmin® Navigation & Fusion Infotainment System
- Chrome Heated/Power Mirrors with Integrated Side Cameras
- Push Button Start
- Primera™ by Ultrafabrics® Reclining/Swivel Power Adjustable Captain's Chairs (Passenger Seat has Electric Footrest)
- Driver & Passenger Overhead Storage Cabinetry
- VIP Tilt/Telescoping Smart Wheel
- Adjustable Brake & Accelerator Pedals
- Cruise Control
- Dash Fans
- Emergency Engine Start Switch
- Air Horns
- Fog Lights
- Power Solar & Privacy Shades on Windshield
- Manual Solar & Privacy Shades on Side Windows
- Solid Surface Entry Steps & Electric Step Cover
- 315/80R 22.5" (Front) & 295/80R 22.5" (Rear) Michelin Radial Tires with Aluminum Wheels (45JA & 45MX)
- 295/80R 22.5" Michelin® Radial Tires with Aluminum Wheels
- Remote Entry & Compartment Door Locks
- Power Drop-Down Hide-Away Overhead Bunk with Cotton Cloud™ Mattress

## AUTOMOTIVE & COCKPIT OPTIONS

- Remove Power Drop-Down Hide-Away Overhead Bunk with Cotton Cloud™ Mattress

## INTERIOR

- Polished Porcelain Tile Flooring
- GoldHeat® Electronic Heated Flooring

- Ceiling Ducted Whisper Air™ Central Cooling System
- LED Lighting & Living Room Pin-Up Lights
- Decorative Ceiling Treatment with Mood Lighting
- High-Gloss Glazed Cabinetry with Solid Wood Raised Panel Cabinet Doors & Nickel Finish Hardware
- Window Solar & Privacy Shades
- Electric Fireplace with Remote Control
- Primera™ by Ultrafabrics® Furniture
- Driver Side Sofa with Bed (40RT)
- Passenger Side Sofa with Bed (45JA)
- Reclining Theater Seating with Footrests
- Ensemble with Sofa & Dream Dinette Booth® (45MX)
- Buffet Dinette with Four (4) Chairs – Includes Two (2) Folding (40RT & 45JA)

## INTERIOR OPTIONS

- Euro Recliner & Desktop
- Driver Side Sofa with Bed - Requires Euro Recliner with Desktop (45JA)
- Driver Side Jack-Knife Sofa (45JA & 45MX)
- Passenger Side Sofa with Bed Requires - Euro Recliner, Desktop & Electric Fireplace Option (40RT)
- Passenger Side Jack-Knife Sofa (40RT)
- Passenger Side Sofa with Bed (45MX)
- Dream Dinette® Booth
- Buffet Dinette with Four (4) Chairs – Includes Two (2) Folding (45MX)

## KITCHEN

- Stainless Steel Residential French Door Refrigerator with In-Door Ice & Water Dispenser
- Recessed Electric Induction Cooktop with Countertop Covers
- Stainless Steel Over-the-Range Convection Microwave Oven
- Residential Fisher Paykel® Dishwasher Drawer
- Solid Surface Countertops & Sink Covers

- Pop-up Outlets in the Kitchen Countertops
- Large Single Bowl Stainless Steel Farmhouse Sink & Single Handle Faucet w/Pull-Down Sprayer
- Designer Tile Backsplash
- 12-volt Attic Fan with Cover & Remote Control

## BEDROOM & BATHROOM

- King Size Bed with Tilt-A-View® Inclining Bed Mechanism
- Bedspread with Throw Pillows
- Electric Fireplace with Remote Control in Bedroom (45JA)
- Ceiling Fan in Bedroom
- USB Charging Ports in Nightstands
- Porcelain Toilet
- Macerator Toilet
- Residential Tile Shower with Teak Shower Seat & Glass Door
- Oxygenics® Shower Head
- Decorative Tile Backsplash in Bathroom
- 12-volt Attic Fan with Cover in Bathroom

## ENTERTAINMENT

- Retractable 55" LED Smart HDTV in Living Area
- 40" TV in Living Area (40RT)
- 32" TV in Cockpit Overhead (45JA & 45MX)
- JBL® Sound Bar with Bluetooth®
- Sony® Blu-Ray DVD Player in Living Area & Bedroom
- Retractable 40" TV in Bedroom (45JA)
- 32" TV in Bedroom (40RT & 45MX)
- Exterior 39" TV on Swivel Bracket with Bluetooth® Sound Bar
- Cable TV & HDMI Video Distribution Ready
- Winegard® Trav'ler HD Satellite Dish (HD Capable with DirecTV in U.S. / Shaw Direct in Canada)
- Winegard® Connect™ 4G LTE Router & WiFi Extender

## ELECTRICAL & PLUMBING

- Cummins Onan® RV QD 10000 Diesel Generator on Power Slideout
- Automatic Generator Start
- 50-amp Shoreline Power Cord & 12-volt Retractable Cord Reel
- 2800-watt PURE SINE Inverter/100-amp Converter
- Triple 15,000 BTU Low-Profile Ducted Air Conditioners with Three (3) Heat Pumps
- Condensation Drainage System
- Energy Management System
- Multiplex Wiring Control System with 7" Screen & App-Enabled
- 200-watt Solar Charging System with Power Controller
- Six (6) Auxiliary House Batteries
- Battery Disconnect Switch
- Exterior GFCI Recept
- Enclosed & Heated Holding Tanks
- E-Z Flow Water Panel with Whole-House Water Filtration
- 12-volt Retractable Fresh Water Hose Reel
- 360° Siphon RV Holding Tank Vent Cap
- Black Tank Flush System
- Outside Shower
- Stackable Washer & Dryer
- Central Vacuum System with Toe-Kick Dustpan
- Aqua-Hot® 400D Hydronic Furnace & Water Heating System



For a complete listing of available features, visit [thormotorcoach.com/tuscany](http://thormotorcoach.com/tuscany).

	40RT	45JA	45MX
Chassis	Freightliner XC-R	Freightliner XC-R	Freightliner XC-R
Gross Vehicle (GVWR)	38,600	46,000	46,000
Gross Combined (GCWR)	48,600	60,660	60,660
Wheel Base	266"	287"	287"
Exterior Length	41'-1"	44'-10"	44'-10"
Exterior Height (w/AC)	12'-9"	12'-10"	12'-10"
Exterior Width (w/o mirrors)	101"	101"	101"
Interior Height (living area)	84"	84"	84"
Awning Size	14'-9" & 19'-8"	18'-6" & 19'-8"	18'-6" & 19'-8"
Fuel (gal)	150	150	150
Fresh/Waste/Gray Water (gal)	91 / 51 / 70	91 / 51 / 70	91 / 51 / 70
Water Heater (gal)	Aqua Hot®	Aqua Hot®	Aqua Hot®
Exterior Storage Capacity (cu. ft.)	215	260	260



**IMPORTANT—PLEASE READ:** This brochure reflects product design, fabrication, material, components and specifications at the date of printing, which date is disclosed below. Please visit us online at [ThorMotorCoach.com](http://ThorMotorCoach.com) or consult with your selling dealership for the latest in standards, options, specification and technical information. Photographs in the brochure may depict optional equipment or may only be available in certain floor plans. Components, appliances and the chassis may have been manufactured in a calendar year before the vehicle's designated model year. All capacities are approximate. The actual length of the vehicle may differ from that indicated in the brochure due to variances in the manufacturing processes and/or installed components. All dry weights are based on standard model features and do not include optional features or equipment. Component part and appliance manufacturers issue limited warranties covering portions of the vehicle not covered under the limited warranty we issue. Copyright Thor Motor Coach, Inc. © MY 05/01/2019

Made to fit.

P.O. Box 1486, Elkhart, IN 46515 Sales Department: 800.860.5658

[thormotorcoach.com/tuscany](http://thormotorcoach.com/tuscany)

