

2018 CORNERSTONE | ANTHEM | ASPIRE | INSIGNIA



ENTEGR  
COACH®



ENTEGR  
COACH®



THE LUXURY  
YOU DESERVE.

## REVERED QUALITY, BREAKTHROUGH TECHNOLOGY

Building on generations of proven craftsmanship, we're constantly pushing the limits of what a motorcoach can be. The 2018 lineup is no different, delivering some of the most advanced vehicles on earth.

- En-telligent™ VegaTouch command center with larger touchscreen controls and HDMI® input
- Blind Spot Monitoring System
- En-telligent Collision Mitigation System from OnGuard™ automatically brakes in dangerous situations
- Electronic stability control recognizes irregularities in steering and helps stabilize the coach to prevent tilting and swaying
- Third brake light signals when the brake is applied
- Low-beam LED headlights
- Passive steer tag axle

Some features not available on all models





# THE QUIETEST RIDING, BEST HANDLING COACH ON THE MARKET TODAY. PERIOD.

## HERE'S WHY:

### 1. SPARTAN® CHASSIS

With more than 30 years of custom chassis manufacturing, Spartan gives us the industry's premier foundation.

### 2. EXCLUSIVE X-BRIDGE™ FRAME

Our exclusive X-Bridge frame adds even more floor strength and structural rigidity, eliminating chassis flex and twisting; with it, the suspension—not the chassis—absorbs road shock and vibration.

### 3. FIVE-INCH-THICK FLOORS

One of the industry's thickest floors starts with several layers of plywood for dramatic reductions in energy transmission, noise and vibration. Cabinets are screwed directly to the wood and tile is laid delicately around them; other manufacturers place cabinets on top of the tile, causing squeaks or cracking.

### 4. RESIDENTIAL-STYLE WALLS AND ROOF

Our roof combines crowned aluminum truss rafters on 16-inch centers with Flexfoil®, fiberglass insulation and 3/8-inch plywood decking. Our walls, along with our front and rear caps, feature tucked-and-glued batting insulation—the same kind of fiberglass insulation found in sound-absorbing theater rooms.

### 5. MONOTUBE GAS PRESSURE SHOCKS

Designed specifically for luxury motorcoaches by Bilstein®, these shocks have 228% more surface area than twin-tube shocks for greater sensitivity and control. They virtually eliminate excessive sway and self-adjust so you don't have to change settings.



### 6. MICHELIN® MOTORHOME TIRES

One of the most trusted names in the business, Michelin's motorhome tires are designed for unparalleled fuel efficiency, high mileage and precise load control.

### 7. DUAL DIESEL EXHAUST FLUID (DEF) FILL PORTS

DEF fill ports on both sides of the coach make it easy to get the most from your fuel—better efficiency, increased power, safer emissions, fewer regenerations and optimized combustion.



**ENTEGRA**  
COACH®



45Y INTERIOR

CASHMERE DÉCOR WITH STONEWALL GREY CABINETRY

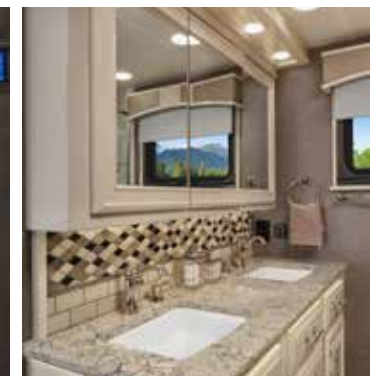



# CORNERSTONE



| Floorplan                    | GVWR (lbs.) | GCWR (lbs.) | Front GAWR (lbs.) | Rear GAWR (lbs.) | Tag GAWR (lbs.) | Wheel Base | Overall Length | Exterior Height w/ A/C & Satellite | Exterior Width | Interior Height | Fresh Water Capacity (gal.) | Grey Waste Water Capacity (gal.) | Black Waste Water Capacity (gal.) |
|------------------------------|-------------|-------------|-------------------|------------------|-----------------|------------|----------------|------------------------------------|----------------|-----------------|-----------------------------|----------------------------------|-----------------------------------|
| 45A, 45B, 45F, 45W, 45X, 45Y | 54,000      | 74,000      | 20,000            | 20,000           | 14,000          | 320"       | 44' 11"        | 12' 11"                            | 101"           | 84"             | 100                         | 62                               | 41                                |

## STANDARD CHASSIS EQUIPMENT

Spartan® K3 raised-rail chassis  
 Cummins® 15-liter ISX turbocharged 605HP engine, 1,950 lb.-ft. torque at 1,200 RPM  
 Allison® 4000 MH 6-speed transmission  
 Reyco® Granning® IFS independent front air suspension  
 Reyco Granning rear suspension  
 20,000-pound hitch with 7/4-pin plug  
 Hadley® air leveling system  
 Bilstein® shocks: 60mm in front and 46mm on rear tag  
 150-gallon fuel tank (dual fill)

## STANDARD CONSTRUCTION FEATURES

X-Bridge™ frames welded onto chassis frame  
 Enclosed, insulated and heated floor and thermostat-controlled heating in storage area  
 Flush-mounted, electric-powered slideout rooms with VegaTouch control

## HEAT, A/C, POWER AND WATER EQUIPMENT

Aqua-Hot® 450 diesel hydronic water and heating system with in-floor heat throughout  
 15,000 BTU low-profile A/Cs (3) with heat pumps, digital thermostat and roof-to-ground condensation drain tubes  
 Onan® 12,500-watt diesel generator with auto-gen start on powered slideout tray  
 3,000-watt pure sine wave inverter (2)  
 L16 AGM batteries (4) (6V/390 amp hours each)  
 Macerator holding tank dump system with electric gate valves and manual backup system

## STANDARD EXTERIOR EQUIPMENT

LED high- and low-beam headlights  
 Lighted grab handle with keypad system  
 Keyless entry with key fob  
 Girard® power entrance door awning with LED lights  
 Girard Ultra window shade and slideout awnings  
 Roof-mounted Girard Vision dual-pitched patio awning with LED lights  
 Chrome, heated, remote-controlled, sideview mirrors with blind spot indicators  
 Exterior 40-inch Samsung® LED HDTV on bracket with extend, tilt and swivel arm with Samsung Soundbar  
 Full-width rear mudflap with chrome "Cornerstone" nameplate

## COCKPIT AMENITIES

Air-cooled, 6-way-power, lumbar, heated, leather driver and passenger seats with integrated 3-point safety belts  
 VIP wood-grain, leather-wrapped, tilt and telescoping steering wheel with integrated controls for radio, cruise and wipers  
 All-glass paneled, dual 9-inch capacitive touchscreen, in-dash infotainment centers with Rand-McNally™ RV navigation, Bluetooth®, SiriusXM™, AM/FM tuner, integrated camera control, house-mode whole-coach audio distribution and integrated VegaTouch coach control  
 JBL® premium audio sound system with speakers, amplifier and subwoofer  
 Color "Total Vision" rear camera and digital side camera

## STANDARD INTERIOR EQUIPMENT

VegaTouch pad system for complete integration of coach controls  
 High-gloss 12-inch x 24-inch porcelain tile floor with granite inlay design  
 Samsung 50-inch 4K UHD TV in living area  
 Samsung 32-inch LED HDTV in front overhead  
 Bose® SoundTouch® 300 sound system in living room  
 In-step storage with pullout tray  
 LED-lit 1,400-watt electric fireplace (45B, 45Y)

## STANDARD KITCHEN EQUIPMENT

Dimmable LED-lit quartz countertops with integrated stainless steel sink  
 Dishwasher with wood raised-panel door front  
 Furrion® RV Chef Collection™ induction cooktop  
 Whirlpool® residential refrigerator with ice maker and water dispenser  
 Whirlpool Gold® 1.9-cubic-foot convection microwave oven

## STANDARD BEDROOM EQUIPMENT

Samsung 32-inch LED HDTV  
 Samsung Soundbar  
 Plush king-size mattress  
 Spacious cedar-lined wardrobe with automatic light(s)

## STANDARD BATHROOM EQUIPMENT

LED-lit quartz countertop(s) with integrated sink(s)  
 Porcelain toilet(s) with push-button flush (master bath)  
 Frameless, clear-glass shower door  
 Porcelain-tiled shower walls and floor with skylight  
 Power vent

## STANDARD SAFETY EQUIPMENT

En-telligent™ Collision Mitigation System equipped with collision warning, adaptive cruise control and electronic stability control  
 En-telligent Blind Spot Monitoring System tuned to detect objects within the lanes of traffic on either side of the vehicle  
 Security system with glass-shatter sensors  
 Motion-sensor security lights (2)  
 Smoke alarm  
 Carbon monoxide detector  
 Security safe

## OPTIONS

Canadian standards  
 Theater seating with power recliners and fixed console  
 Desk with 50-inch TV lift, fireplace and hide-a-bed (45A, 45X)  
 Winegard® TRAV'LER® satellite dish with DIRECTV® (US) or Shaw Direct (CA)  
 Dual 100-watt solar panels with Morningstar SunSaver™ Duo solar panel charge controller  
 WiFi extender antenna

For a full list of standards and options, visit [EntegraCoach.com](http://EntegraCoach.com)

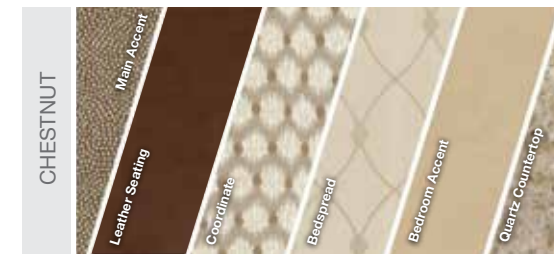





44B INTERIOR  
BUTTERSCOTCH DÉCOR WITH NATURAL GLAZED CHERRY CABINETRY





# ANTHEM



| Floorplan | GVWR (lbs.) | GCWR (lbs.) | Front GAWR (lbs.) | Rear GAWR (lbs.) | Tag GAWR (lbs.) | Wheel Base | Overall Length | Exterior Height w/ A/C & Satellite | Exterior Width | Interior Height | Fresh Water Capacity (gal.) | Grey Waste Water Capacity (gal.) | Black Waste Water Capacity (gal.) |
|-----------|-------------|-------------|-------------------|------------------|-----------------|------------|----------------|------------------------------------|----------------|-----------------|-----------------------------|----------------------------------|-----------------------------------|
| 42DEQ     | 49,000      | 64,000      | 17,000            | 20,000           | 12,000          | 296"       | 43' 1"         | 12' 7"                             | 101"           | 84"             | 100                         | 62                               | 41                                |
| 42RBQ     | 49,000      | 64,000      | 17,000            | 20,000           | 12,000          | 296"       | 43' 1"         | 12' 9"                             | 101"           | 84"             | 100                         | 62                               | 41                                |
| 44A, 44F  | 49,000      | 64,000      | 17,000            | 20,000           | 12,000          | 320"       | 44' 11"        | 12' 8"                             | 101"           | 84"             | 100                         | 62                               | 41                                |
| 44B       | 49,000      | 64,000      | 17,000            | 20,000           | 12,000          | 320"       | 44' 11"        | 12' 6"                             | 101"           | 84"             | 100                         | 62                               | 41                                |

## STANDARD CHASSIS EQUIPMENT

Spartan® K2 raised-rail chassis  
 Cummins® ISL turbocharged 450HP engine, 1,250 lb.-ft. torque at 1,400 RPM  
 Allison® 3000 MH 6-speed transmission  
 Reyco® Granning® IFS independent front air suspension  
 Reyco Granning rear suspension  
 15,000-pound hitch with 7/4-pin plug  
 Hadley® air leveling system  
 Bilstein® shocks: 60mm in front and 46mm on rear tag  
 150-gallon fuel tank (dual fill)

## STANDARD CONSTRUCTION FEATURES

X-Bridge™ frames welded onto chassis frame  
 Enclosed, insulated and heated floor and thermostat-controlled heating in storage area  
 Flush-mounted, electric-powered slideout rooms with VegaTouch control

## HEAT, A/C, POWER AND WATER EQUIPMENT

Aqua-Hot® 450 diesel hydronic water and heating system with in-floor heat throughout  
 15,000 BTU low-profile A/Cs (3) with heat pumps, digital thermostat and roof-to-ground condensation drain tubes  
 Onan® 12,500-watt diesel generator with auto-gen start on powered slideout tray  
 3,000-watt pure sine wave inverter (2)  
 L16 AGM batteries (4) (6V/390 amp hours each)  
 Macerator holding tank dump system with manual gate valves

## STANDARD EXTERIOR EQUIPMENT

LED high- and low-beam headlights  
 Lighted grab handle with keypad system  
 Keyless entry with key fob  
 Girard® power entrance door awning with LED lights  
 Girard Ultra window shade awning and Ultra slideout awnings  
 Roof-mounted Girard Vision dual-pitched patio awning with LED lights  
 Chrome, heated, remote-controlled, sideview mirrors with blind spot indicators  
 Exterior 40-inch Samsung LED HDTV on bracket with extend, tilt and swivel arm with Samsung Soundbar  
 Full-width rear mudflap with chrome "Anthem" nameplate

## COCKPIT AMENITIES

6-way-power, lumbar, Ultraleather® driver and passenger seats with integrated 3-point safety belts  
 VIP wood-grain, leather-wrapped, tilt and telescoping steering wheel with integrated controls for radio, cruise and wipers  
 All-glass paneled, dual 9-inch capacitive touchscreen, in-dash infotainment centers with Rand-McNally™ RV navigation, Bluetooth®, SiriusXM™, AM/FM tuner, integrated camera control, house-mode whole-coach audio distribution and integrated VegaTouch coach control  
 JBL® premium audio sound system with speakers, amplifier and subwoofer  
 Color, high-definition, digital side and rearview cameras

## STANDARD INTERIOR EQUIPMENT

VegaTouch pad system for complete integration of coach controls  
 High-gloss 12-inch x 24-inch porcelain tile floor  
 Samsung 50-inch 4K UHD TV (42DEQ, 44A, 44B); Samsung 48-inch 4K UHD TV (42RBQ, 44F) in living area  
 Samsung 32-inch LED HDTV in front overhead  
 Bose SoundTouch® 300 sound system in living room  
 In-step storage with pullout tray  
 LED-lit 1,400-watt electric fireplace (42DEQ, 42RBQ, 44B)

## STANDARD KITCHEN EQUIPMENT

Dimmable LED-lit solid-surface countertops with integrated stainless steel sink  
 Dishwasher with wood raised-panel door front  
 Furrion® RV Chef Collection™ induction cooktop  
 Whirlpool® residential refrigerator with ice maker and water dispenser  
 Whirlpool Gold® 1.9-cubic-foot convection microwave oven

## STANDARD BEDROOM EQUIPMENT

Samsung 32-inch LED HDTV  
 Samsung Soundbar  
 Plush king-size mattress  
 Spacious cedar-lined wardrobe with automatic light(s)

## STANDARD BATHROOM EQUIPMENT

LED-lit solid-surface countertops with integrated sink  
 Porcelain toilet(s) with push-button flush (master bath)  
 Clear-glass shower door  
 Porcelain-tiled shower walls with skylight  
 Power vent

## STANDARD SAFETY EQUIPMENT

En-telligent™ Blind Spot Monitoring System tuned to detect objects within the lanes of traffic on either side of the vehicle  
 Security system with glass-shatter sensors  
 Motion-sensor security lights (2)  
 Smoke alarm  
 Carbon monoxide detector  
 Security safe

## OPTIONS

Canadian standards  
 Theater seating with power recliners and fixed console  
 Desk with TV lift, fireplace and hide-a-bed (44A)  
 Winegard® TRAV'LER® satellite dish with DIRECTV® (US) or Shaw Direct (CA)  
 Dual 100-watt solar panels with Morningstar SunSaver™ Duo solar panel charge controller  
 WiFi extender antenna

For a full list of standards and options, visit [EntegraCoach.com](http://EntegraCoach.com)





44R INTERIOR  
SILVER CLOUD DÉCOR WITH TUSCAN GLAZED CHERRY CABINETRY





# ASPIRE



| Floorplan          | GVWR (lbs.) | GCWR (lbs.) | Front GAWR (lbs.) | Rear GAWR (lbs.) | Tag GAWR (lbs.) | Wheel Base | Overall Length | Exterior Height w/ A/C & Satellite | Exterior Width | Interior Height | Fresh Water Capacity (gal.) | Grey Waste Water Capacity (gal.) | Black Waste Water Capacity (gal.) |
|--------------------|-------------|-------------|-------------------|------------------|-----------------|------------|----------------|------------------------------------|----------------|-----------------|-----------------------------|----------------------------------|-----------------------------------|
| 38M, 40P           | 41,000      | 56,000      | 17,000            | 24,000           | N/A             | 261"       | 40' 6"         | 12' 8"                             | 101"           | 84"             | 100                         | 62                               | 41                                |
| 42DEQ, 42RBQ       | 49,000      | 64,000      | 17,000            | 20,000           | 12,000          | 296"       | 43' 1"         | 12' 8"                             | 101"           | 84"             | 100                         | 62                               | 41                                |
| 44B, 44R, 44U, 44W | 49,000      | 64,000      | 17,000            | 20,000           | 12,000          | 320"       | 44' 11"        | 12' 8"                             | 101"           | 84"             | 100                         | 62                               | 41                                |

## STANDARD CHASSIS EQUIPMENT

Spartan® K2 raised-rail chassis  
 Cummins® ISL turbocharged 450HP engine, 1,250 lb.-ft. torque at 1,400 RPM  
 Allison® 3000 MH 6-speed transmission  
 Reyco® Granning® IFS independent front air suspension  
 Reyco Granning rear suspension  
 15,000-pound hitch with 7/4-pin plug (10,000-pound hitch on 38M and 40P)  
 Bilstein® 46mm shocks  
 100-gallon fuel tank (38M, 40P), 150-gallon fuel tank (dual fill) (42DEQ, 42RBQ, 44B, 44R, 44U, 44W)

## STANDARD CONSTRUCTION FEATURES

X-Bridge™ frames welded onto chassis frame  
 Enclosed, insulated and heated floor and thermostat-controlled heating in storage area  
 Flush-mounted, electric-powered slideout rooms with remote control

## HEAT, A/C, POWER AND WATER EQUIPMENT

Aqua-Hot® 400 diesel hydronic water and heating system with in-floor heat throughout  
 15,000 BTU low-profile A/Cs (3) with heat pumps, digital thermostat and roof-to-ground condensation drain tubes  
 Onan® 10,000-watt diesel generator with auto-gen start on slideout tray  
 3,000-watt pure sine wave inverter  
 L16 AGM batteries (2) (6V/390 amp hours each)  
 Macerator holding tank dump system with manual gate valves

## STANDARD EXTERIOR EQUIPMENT

LED high-beam headlights and halogen low-beam headlights  
 Lighted grab handle with keypad system  
 Keyless entry with key fob  
 Girard® power entrance door awning with LED lights  
 Girard window shade awning and slideout awnings  
 Roof-mounted Girard Vision dual-pitched patio awning with LED lights  
 Chrome, heated, remote-controlled, sideview mirrors with integrated cameras  
 Exterior 40-inch Samsung® LED HDTV on bracket with extend, tilt and swivel arm with Samsung Soundbar  
 Full-width rear mudflap with chrome "Aspire" nameplate

## COCKPIT AMENITIES

6-way-power, lumbar, Ultraleather® driver and passenger seats with integrated 3-point safety belts  
 VIP leather-wrapped, tilt and telescoping steering wheel with integrated controls for cruise and wipers  
 Dual 7-inch touchscreen, in-dash infotainment centers with Rand-McNally™ RV navigation, Bluetooth®, SiriusXM™, AM/FM tuner and integrated camera control  
 JBL® premium audio sound system with speakers, amplifier and subwoofer  
 Color camera system with side and digital rearview cameras

## STANDARD INTERIOR EQUIPMENT

Multiplex-controlled lighting system  
 High-gloss 12-inch x 24-inch porcelain tile floor  
 Samsung 50-inch LED HDTV (42DEQ, 44B, 44R, 44W); Samsung 48-inch LED HDTV (38M, 42RBQ, 44U) in living area  
 Samsung 40-inch LED HDTV (40P) in front overhead (32-inch LED HDTV not available in 40P)  
 Samsung Soundbar in living room  
 In-step storage with pullout tray

## STANDARD KITCHEN EQUIPMENT

Dimmable LED-lit solid-surface countertops with integrated stainless steel sink  
 Furrion® RV Chef Collection™ induction cooktop  
 Whirlpool® residential refrigerator with ice maker and water dispenser  
 Whirlpool Gold® 1.9-cubic-foot convection microwave oven

## STANDARD BEDROOM EQUIPMENT

Samsung 32-inch LED HDTV  
 Samsung Soundbar  
 Plush king-size foam mattress  
 Spacious wardrobe with automatic light(s)

## STANDARD BATHROOM EQUIPMENT

LED-lit solid-surface countertop(s) with integrated sink  
 Porcelain toilet(s) with push-button flush (master bath)  
 Clear-glass shower door  
 One-piece fiberglass shower enclosure with skylight  
 Power vent

## STANDARD SAFETY EQUIPMENT

Security system with glass-shatter sensors  
 Motion-sensor security lights (2)  
 Smoke alarm  
 Carbon monoxide detector  
 Propane alarm  
 Security safe

## OPTIONS

Canadian standards  
 Dishwasher drawer  
 Theater seating with power recliners and fixed console  
 Desk with TV lift and fireplace (44W)  
 Winegard® TRAV'LER® satellite dish with DIRECTV® (US) or Shaw Direct (CA)  
 Solar panels  
 Slideout storage tray  
 Second Girard patio awning  
 WiFi extender antenna  
 2 additional AGM batteries (4 total) (n/a on 38M, 40P)

For a full list of standards and options, visit [EntegraCoach.com](http://EntegraCoach.com)

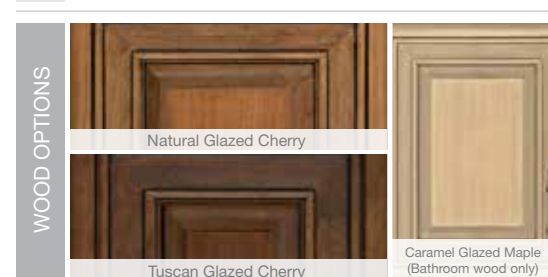
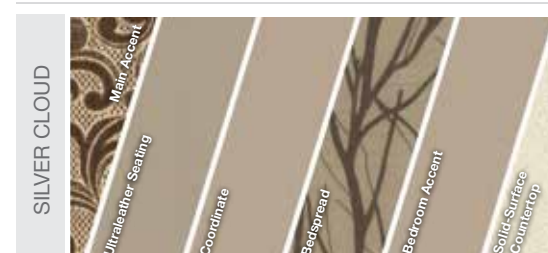
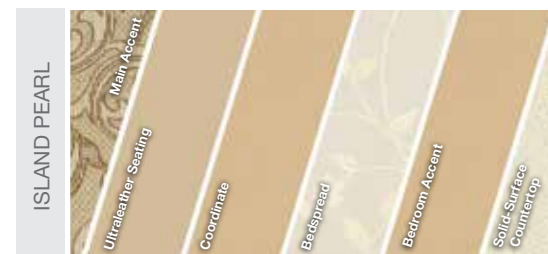



44W INTERIOR  
CREAM DÉCOR WITH NATURAL GLAZED CHERRY CABINETRY





# INSIGNIA



| Floorplan | GVWR (lbs.) | GCWR (lbs.) | Front GAWR (lbs.) | Rear GAWR (lbs.) | Tag GAWR (lbs.) | Wheel Base | Overall Length | Exterior Height w/ A/C & Satellite | Exterior Width | Interior Height | Fresh Water Capacity (gal.) | Grey Waste Water Capacity (gal.) | Black Waste Water Capacity (gal.) |
|-----------|-------------|-------------|-------------------|------------------|-----------------|------------|----------------|------------------------------------|----------------|-----------------|-----------------------------|----------------------------------|-----------------------------------|
| 44B, 44W  | 47,660      | 62,660      | 15,600            | 20,000           | 12,000          | 320"       | 44' 11"        | 12' 11"                            | 101"           | 84"             | 100                         | 62                               | 41                                |

## STANDARD CHASSIS EQUIPMENT

Spartan® K2 raised-rail chassis  
 Cummins® ISL turbocharged 450HP engine, 1,250 lb.-ft. torque at 1,400 RPM  
 Allison® 3000 MH 6-speed transmission  
 15,000-pound hitch with 7/4-pin plug  
 Bilstein® 46mm shocks  
 100-gallon fuel tank (dual fill)

## STANDARD CONSTRUCTION FEATURES

X-Bridge™ frames welded onto chassis frame  
 Enclosed, insulated and heated floor and thermostat-controlled heating in storage area  
 Flush-mounted, electric-powered slideout rooms with remote control

## HEAT, A/C, POWER AND WATER EQUIPMENT

Aqua-Hot® 400-LP hydronic water and heating system with in-floor heat throughout  
 13,500 BTU low-profile A/Cs (3) with heat pumps, digital thermostat and roof-to-ground condensation drain tubes  
 Onan® 10,000-watt diesel generator with auto-gen start on slideout tray  
 3,000-watt pure sine wave inverter  
 L16 AGM batteries (2) (6V/390 amp hours each)  
 Macerator holding tank dump system with manual gate valves

## STANDARD EXTERIOR EQUIPMENT

Halogen high- and low-beam headlights  
 Lighted grab handle with keypad system  
 Keyless entry with key fob  
 Carefree® power entrance door awning with LED lights  
 Carefree window shade and slideout awnings  
 Girard® Ultra power patio awning with LED lights  
 Heated, remote-controlled, sideview mirrors with integrated cameras  
 Exterior 40-inch Insignia™ LED HDTV on bracket with extend, tilt and swivel arm with Insignia Soundbar  
 Full-width rear mudflap with chrome "Insignia" nameplate

## COCKPIT AMENITIES

Power-adjustable driver and passenger seats with integrated 3-point safety belts  
 VIP leather-wrapped, tilt and telescoping steering wheel with integrated controls for cruise and wipers  
 9-inch touchscreen, in-dash infotainment center with Rand-McNally™ RV navigation, Bluetooth®, SiriusXM™, AM/FM tuner and integrated camera control  
 JBL® premium audio sound system  
 Color side and rearview cameras

## STANDARD INTERIOR EQUIPMENT

Multiplex-controlled lighting system  
 Wood-like porcelain tile floor  
 Insignia 50-inch LED HDTV in living area  
 Insignia 32-inch LED HDTV in front overhead  
 Insignia Soundbar in living room

## STANDARD KITCHEN EQUIPMENT

LED-lit solid-surface countertops with integrated stainless steel sink  
 Furrion® RV Chef Collection™ induction cooktop  
 Whirlpool® residential refrigerator with ice maker and water dispenser  
 Whirlpool Gold® 1.9-cubic-foot convection microwave oven

## STANDARD BEDROOM EQUIPMENT

Insignia 32-inch LED HDTV  
 Plush king-size foam mattress  
 Spacious wardrobe with automatic light(s)

## STANDARD BATHROOM EQUIPMENT

LED-lit solid-surface countertop(s) with integrated sink  
 Porcelain toilet(s) with push-button flush (master bath)  
 Clear-glass shower door  
 One-piece fiberglass shower enclosure with skylight  
 Power vent

## STANDARD SAFETY EQUIPMENT

Security lights (3)  
 Smoke alarm  
 Carbon monoxide detector  
 Propane alarm

## OPTIONS

Canadian standards  
 LED-lit 1,400-watt electric fireplace (44B)  
 Theater seating with manual recliners and fixed console  
 Winegard® TRAV'LER® satellite dish with DIRECTV® (US) or Shaw Direct (CA)  
 Solar power prep  
 Optional front overhead TV  
 Optional central vacuum system  
 WiFi extender antenna  
 2 additional AGM batteries (4 total)

For a full list of standards and options, visit [EntegreCoach.com](http://EntegreCoach.com)

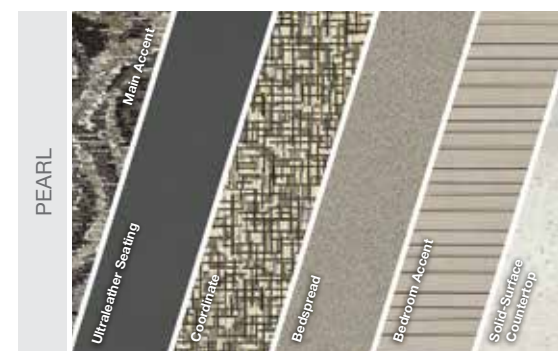
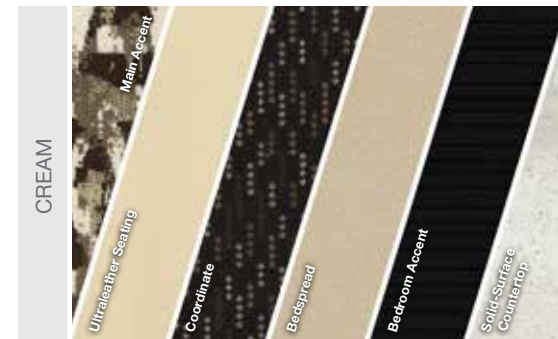
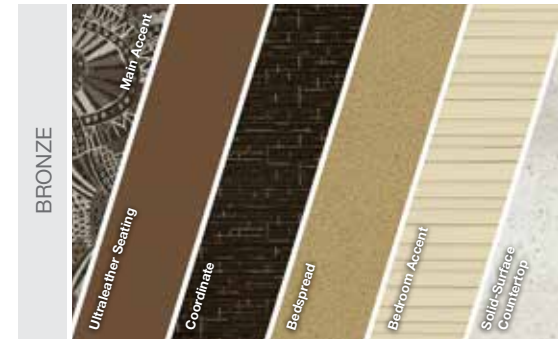

## CORNERSTONE FLOORPLANS



45A | OPTIONS: A AND E; B; C



45B | OPTIONS: B; D



45F | OPTIONS: L\*



45W | OPTIONS: B; C

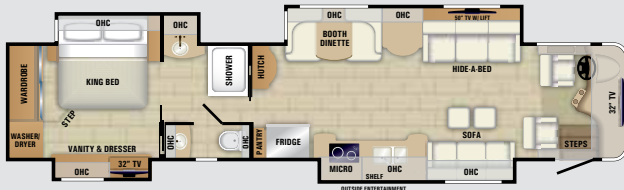

45X | OPTIONS: F; G AND M; L



45Y | OPTIONS: B; D

## ANTHEM FLOORPLANS



42DEQ | OPTIONS: B; D



42RBQ | OPTIONS: E, F AND H



44A | OPTIONS: A AND E; B; C



44B | OPTIONS: B; D



44F | OPTIONS: L\*

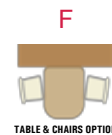
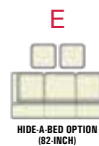
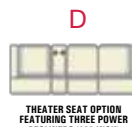



## ASPIRE FLOORPLANS



38M | OPTIONS: B; C



40P | OPTIONS: B; I; L



42DEQ | OPTIONS: B; D



42RBQ | OPTIONS: F, H AND M



44B | OPTIONS: B; D



44R | OPTION C



44U | OPTION D



44W | OPTIONS: B; C

## INSIGNIA FLOORPLANS



44B | OPTIONS: B; K



44W | OPTIONS: B; J



G

DESK W/ TV LIFT  
OPTION



H

EZ BED OPTION  
(49-INCH)

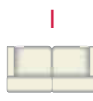

I

HIDE-A-BED OPTION  
(60-INCH)

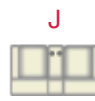

J

THEATER SEAT OPTION  
FEATURING TWO  
RECLINERS (82-INCH)

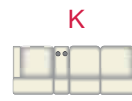

K

THEATER SEAT OPTION  
FEATURING THREE  
RECLINERS (100-INCH)

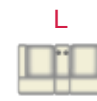

L

THEATER SEAT OPTION  
FEATURING TWO  
POWER  
RECLINERS (74-INCH)

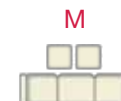

M

HIDE-A-BED OPTION  
(74-INCH)

\*Door side only

CORNERSTONE PAINT SELECTIONS



CAYENNE



CHAMPAGNE



ELECTRIC BLUE

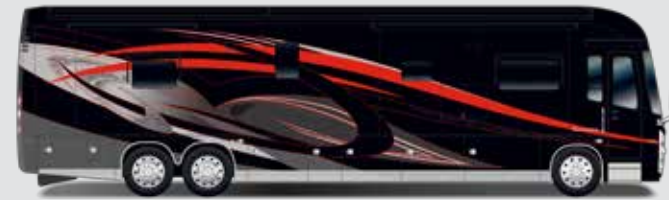

FIRE RED



SUNLIT

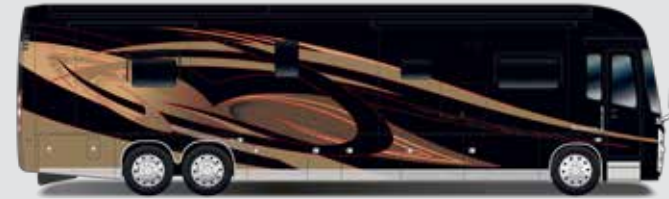

TOPAZ

ANTHEM PAINT SELECTIONS



FIRESTORM



GOLD RIBBON



RICH CHOCOLATE



VICTORY BLUE



ASPIRE PAINT SELECTIONS



ANNIVERSARY GOLD



AUTUMN BERRY



CALIFORNIA CHROME



GOLDEN GARNET



SWEET VICTORY



WINDSWEPT

INSIGNIA PAINT SELECTIONS



FLASH POINT



MAHOGANY RED



SOLAR FLARE



SUPERIOR BLUE



ENTEGRACOACH, INC., P.O. BOX 460, MIDDLEBURY, IN 46540

[WWW.ENTEGRACOACH.COM](http://WWW.ENTEGRACOACH.COM)

Gross Vehicle Weight Rating (GVWR): The maximum permissible weight of the motorcoach, including the Unloaded Vehicle Weight (UVW) plus passengers, personal items, all cargo, fluids, options and dealer-installed accessories. The GVWR is equal to or greater than the sum of the UVW and the Cargo Carrying Capacity. Gross Axle Weight Rating (GAWR): The maximum allowable weight each axle assembly is designed to carry, as measured at the tires, therefore including the weight of the axle assembly itself. Gross Combined Weight Rating (GCWR): The maximum allowable combined weight of the motorcoach used as a tow vehicle and the attached towed vehicle.

Entegra Coach, Inc. | P.O. Box 460 | Middlebury, IN 46540 See dealer for further information and prices. All information in this brochure and on [www.entegracoach.com](http://www.entegracoach.com) is the latest available at the time of publication approval. Entegra Coach reserves the right to make changes and to discontinue models without notice or obligation. Photography may show optional equipment or props used for decoration purposes only. RVs built for sale in Canada may differ to conform to Canadian codes. ENTEGRA COACH, JAYCO and the JAYCO BIRD IN FLIGHT are registered trademarks of Jayco, Inc. Printed in U.S.A. 30K 05/17 ©2017 Entegra Coach, Inc. 274786



ENTEGRACOACH  
COACH®